

# Intellian® i9P

***Most Powerful Marine Satellite TV Antenna  
for Commercial Vessels & Super Yachts***

**Intellian® i9P** The most powerful satellite TV antenna system ideal for both recreational and commercial vessels over 80 feet, cruising across the nations. The Intellian i9P makes the fastest, steadiest and most reliable satellite reception possible even in the far ocean with the roughest marine weather condition.

- *All-in-one system for International Coverage Conversion*
- *Wide Range Search & Dynamic Beam Tilting Technology*
- *Most Powerful Performance and Reliability*
- *Seamless Viewing (Automatic Satellite Switch) of All DISH Network and Bell TV Channels.*  
*Available with DISH MIM (Multi-satellite Interface Multi-switch)*

For more information, visit [www.intelliantech.com](http://www.intelliantech.com)



## **Most Powerful Performance**

34 inch dish diameter with nationwide coverage for North & South America, Europe and the regional service around the globe.

## **All-in-One System**

Auto Skew Angle Control System, GPS and extended elevation range provided as a default option allow the i9P to have enhanced signal receptions in weak satellite signal coverage areas and have accuracy and easy operation wherever the vessel sails.

## **Faster Signal Acquisition**

Intellian's exclusive Wide Range Search (WRS) algorithm allows the antenna to search, find and lock on to a signal with incredible speed and accuracy.

## **A Firm Hold on the Signal**

Intellian's exclusive Dynamic Beam Tilting (DBT) uses a high performance, constantly adjusting sub-reflector which allows the antenna to remain the strongest signal at all times while the vessel is cruising at high speed.

## **Tune in Your Favorite HDTV Channels**

Intellian's i9P provides HD channels from the Ku-band. The HD module is actually built-in to the Antenna Control Unit of the Intellian i9P for seamless integration and easy installation.

## **Built-in GPS**

The Intellian i9P includes a built-in GPS for easier operation and faster signal acquisition.

## **User-friendly Operation**

Antenna Control Unit (ACU), which is supplied as a default package, gives you the user-friendly operation for various function.

**Intellian®**

# Intellian® i9P

## Most Powerful Marine Satellite TV Antenna for Commercial Vessels & Super Yachts

### Key Features

#### Fully Automated System

Automatic satellite search and identification  
2-axis step motors to stabilize the pedestal

#### Enhanced Antenna

Highly efficient 34 inch parabolic antenna enables 44dBW of minimum EIRP.  
RHCP / LHCP, Vertical / Horizontal polarization

#### Wide Range Search (WRS) Algorithm

Competitor methods search for the narrow-bandwidth of the main lobe.  
However Intellian's exclusive WRS searches for the wide range of side lobes and jumps up to the main lobe, providing faster satellite acquisition.

#### Dynamic Beam Tilting (DBT) Technology

A high-speed sub-reflector rotates off axis, checking signal strength at 50 times per second and compensating the tracking direction. Less movement of the main-reflector means less noise and extends the product life.

#### Fully Automated Digital Video Broadcasting (DVB) Identification

DVB Decoder with CPLD enables high speed identification.

#### New Type Antenna Control Unit

Easy to change and update satellite information  
Easy antenna status check and automatic diagnosis  
Easy antenna control using PC interface

#### Automatic Polarization (Skew-angle) Control

Automatic Skew Angle Control System (-90°~ +90°) for Linear Horizontal / Vertical Polarization.

#### Built-in GPS and NMEA 0183 Interface Port

The i9P includes a built-in GPS inside of the Antenna Unit for faster signal acquisition.  
The ship's GPS can also be connected through the NMEA 0183 port on the rear panel of the ACU.

### Technical Specifications

Part #	Specifications
B2-914S	Intellian i9 Satellite TV Antenna System ( US )
B2-910Q	Intellian i9 Satellite TV Antenna System ( Europe )
Physical	
Radome Height	44.9 in ( 114 cm )
Radome Diameter	44.5 in ( 113 cm )
Antenna Dish Diameter	33.5 in ( 85 cm )
Weight	121.2 lbs ( 55 kg )
Environmental	
Operating Temp. Range	-13°F to +131°F ( -25°C to +55°C )
Storage Temp. Range	-22°F to +158°F ( -30°C to +70°C )
Water Ingress	IPX6
Approvals	CE / FCC
Warranty	3 Years Parts and 1 Year Labor
Performance	
Reception Frequency	Ku-band ( 10.7 ~ 12.75 GHz )
Polarization	RHCP / LHCP, Vertical / Horizontal
Minimum EIRP	44 dBW
Azimuth Range	680°
Elevation Range	-15° to +90°
Ship's Motion	Roll ±25°, Pitch ±15°
Roll & Pitch Response Rate	30° / Second
Turn Rate	30° / Second
RF Outputs	Dual / Quad Output
Antenna Control Unit	
Dimensions (WxDxH)	7.0 in x 8.5 in x 2.1 in ( 17.8 cm x 21.7 cm x 5.4 cm )
Weight	2.6 lbs ( 1.2 kg )
Display	2 Line 20 Character VFD Module
Control Key	5 Integrated Push Buttons
Power Input	9 ~ 30 VDC ( Typ. 30W, Max. 50W )
GPS Interface	NMEA0183

### System Diagram

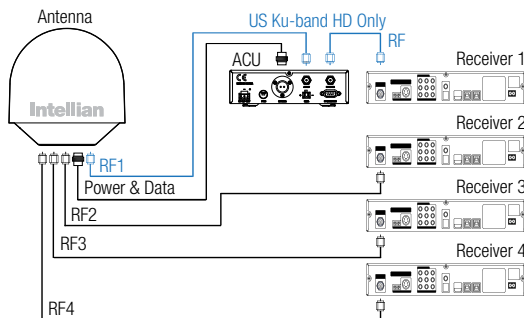

### Antenna Dimensions

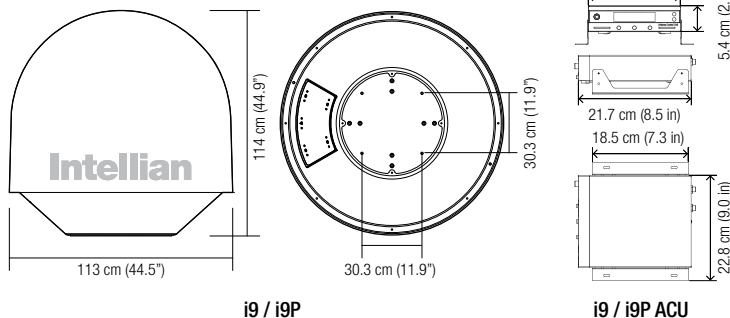

# Intellian®

**Americas**  
Intellian Technologies USA, Inc.  
9004 Research Drive  
Irvine, CA 92618, USA

Tel +1-949-727-4498  
Toll Free +1-888-201-9223  
Fax +1-949-271-4183  
Email info@intelliantech.com

**Europe**  
Intellian B.V.  
Bristolstraat 1, 3047AB  
Rotterdam, Netherlands

Tel +31-1-0820-8655  
Fax +31-1-0820-8656  
Email info@intelliantech.com

**MEA & APAC**  
Intellian Technologies, Inc.  
2F Dongik Bldg., 98, Nonhyun-dong,  
Kangnam-gu, Seoul 135-010, Korea

Tel +82-2-511-2244  
Fax +82-2-511-2235  
Email info@intelliantech.com

ISO 9001 Certified  
For more info, visit [intelliantech.com](http://intelliantech.com)