

# RUGGED.

DOCKING STATIONS AND VEHICLE MOUNTS



**NEW**

## 12" Locking Slide Arm

Placement	Tilt	Rotates	Weight	Height	Width	Depth
Any <i>Upper Tube, Complete Pole, Low Profile Brackets</i> or any flat surface	<b>Yes</b> - up to 90° fore	Motion Attachment - 360° Entire arm - 360° can lock at every 22.5°	10.67 lbs	5.37"	8.54"	18.42"

### Features

- Motion Attachment can rotate 360° allowing for maximum flexibility in computer placement
- The entire arm can rotate around 360° locking at every 22.5°
- To rotate the arm simply pull the front lever out, rotate to desired position and then release the lever
- 12" locking arm has 6 locking points 1.81" apart
- Locking pin can be placed on either side of the base giving the user easy access no matter where the arm is installed
- Can be mounted directly to a flat surface or on any *Upper Tube, Complete Pole* or *Low Profile Bracket*. A backing plate is included with the arm
- Heavy gauge steel construction for long-term durability
- Black powdercoat finish for maximum corrosion resistance

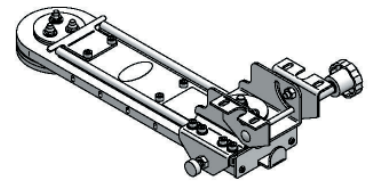

Item No. **7160-0053**



 **GAMBER  
JOHNSON**<sup>®</sup>  
Very Well Connected<sup>™</sup>

3001 Borham Ave  
Stevens Point, WI 54481  
Phone: 800-456-6868  
Fax: 715-344-8845

Email: [gamberj@gamberjohnson.com](mailto:gamberj@gamberjohnson.com)  
Website: [www.gamberjohnson.com](http://www.gamberjohnson.com)