

INSTALLATION INSTRUCTIONS

Product**7160-0201**

CRADLE, DELL E-6400, E-6400 ATG

Revision

Rev. A

Form

INST-438

The Dell E-6400 and E-6400 ATG cradle allows a Dell E-Port or E-Port Plus port replicator and Dell E 6400 or 6400 ATG computer to be used in a mobile application.

Tools Needed

#2 Philips screw driver

11/32 box wrench

5/32 hex-key wrench

Mounting the Port Replicator

1. Open hardware bag 7120-0468 with the port replicator mounting hardware.
2. Position the port replicator using the bent tabs on the deck of the cradle as guides.
3. Secure lower section of the replicator using the left and right lower mounting brackets and (2) #8-32 x .38 machine screws.
4. Ensure the angle of the upper tab on the lower brackets is parallel with the angle of the port replicator.
5. Secure the rear of replicator using the left and right rear support brackets and (4) #8 flat washers with (4) #8 nylon lock nuts.
6. Ensure the left and right rear support brackets do not block any replicator ports.
7. Twist the 4 vinyl caps onto the unused threaded studs.

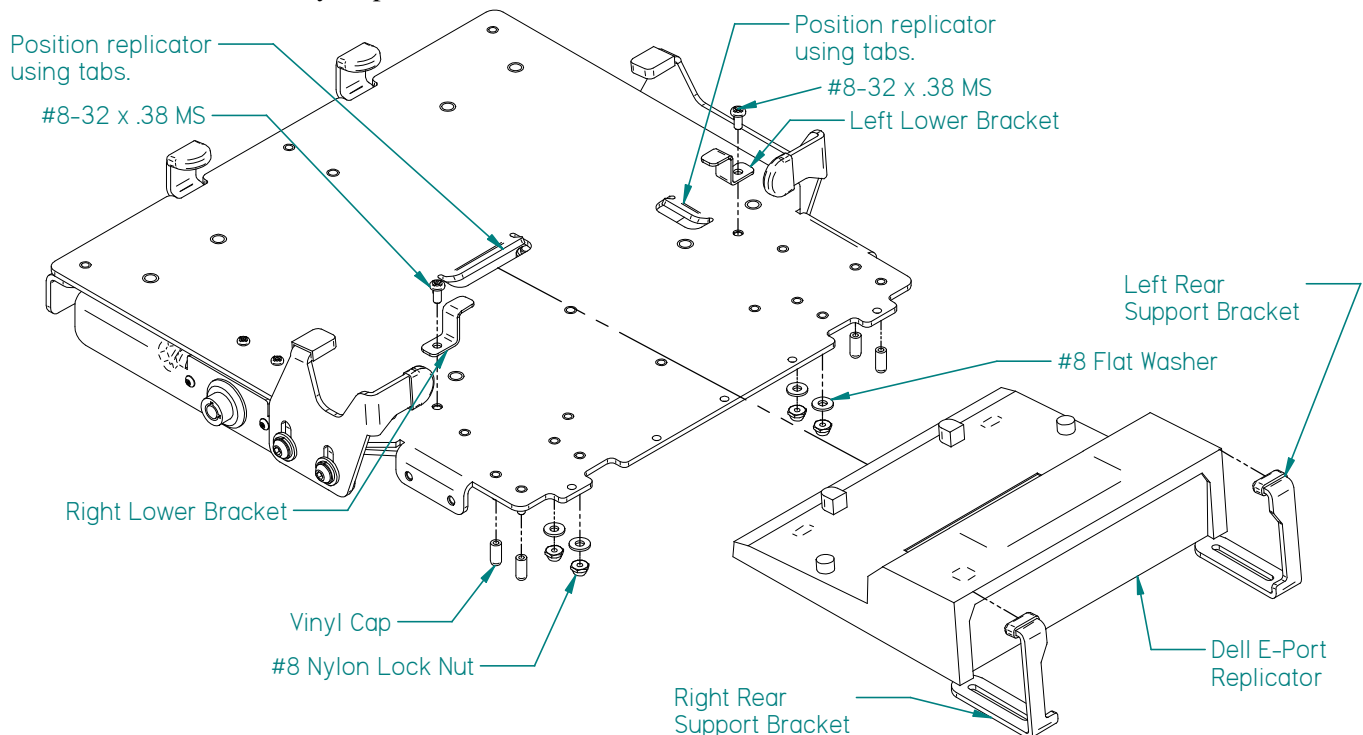
**Figure 1****Product Mounting Disclaimer**

Gamber-Johnson is not liable under any theory of contract or tort law for any loss, damage, personal injury, special, incidental or consequential damages for personal injury or other damage of any nature arising directly or indirectly as a result of the improper installation or use of its products in vehicle or any other application. In order to safely install and use Gamber-Johnson products full consideration of vehicle occupants, vehicle systems (i.e., the location of fuel lines, brakes lines, electrical, drive train or other systems), air-bags and other safety equipment is required. Gamber-Johnson specifically disclaims any responsibility for the improper use or installation of its products not consistent with the original vehicle manufactures specifications and recommendations, Gamber-Johnson product instruction sheets, or workmanship standards as endorsed through the Gamber-Johnson Certified Installer Program. The OEM port replicators used in docking cradles are not warranted by Gamber-Johnson.

If you need assistance or have questions, call Gamber-Johnson at 1-800-456-6868



Very Well Connected™

INSTALLATION INSTRUCTIONS

Product

7160-0201
CRADLE, DELL E-6400, E-6400 ATG

Revision

Rev. A

Form

INST-438

Adjusting the Side Brackets

1. After the port replicator has been installed open the cradle by pushing the latch button and pulling the sides outward.
2. Mount the computer onto the port replicator. A secure mount is confirmed with an audible click of the Dell port replicator.
3. Loosen the side hooks using the 5/32 hex-key wrench.
4. Close the cradle and align the left and right side hooks.
5. Secure the left and right side hooks and computer using the 5/32 hex-key wrench.

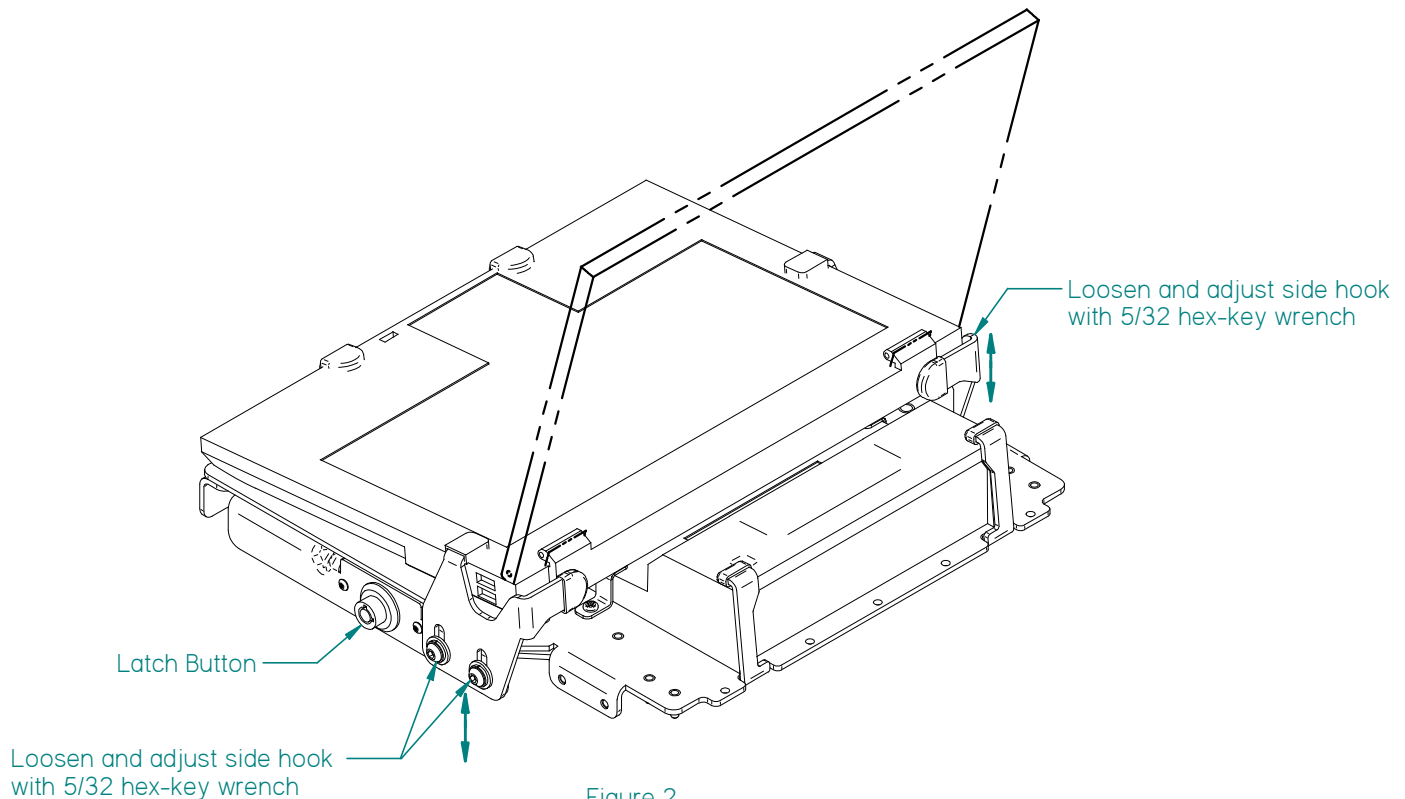

Figure 2

Product Mounting Disclaimer

Gamber-Johnson is not liable under any theory of contract or tort law for any loss, damage, personal injury, special, incidental or consequential damages for personal injury or other damage of any nature arising directly or indirectly as a result of the improper installation or use of its products in vehicle or any other application. In order to safely install and use Gamber-Johnson products full consideration of vehicle occupants, vehicle systems (i.e., the location of fuel lines, brakes lines, electrical, drive train or other systems), air-bags and other safety equipment is required. Gamber-Johnson specifically disclaims any responsibility for the improper use or installation of its products not consistent with the original vehicle manufactures specifications and recommendations, Gamber-Johnson product instruction sheets, or workmanship standards as endorsed through the Gamber-Johnson Certified Installer Program. The OEM port replicators used in docking cradles are not warranted by Gamber-Johnson.

If you need assistance or have questions, call Gamber-Johnson at 1-800-456-6868



Very Well Connected™

INSTALLATION INSTRUCTIONS

Product

7160-0201
CRADLE, DELL E-6400, E-6400 ATG

Revision

Rev. A

Form

INST-438

Motion Attachment

Secure the motion attachment with (4) .25-20 x.50 socket button head cap screws supplied in hardware bag 7120-0468 using a 5/32 hex-key wrench.

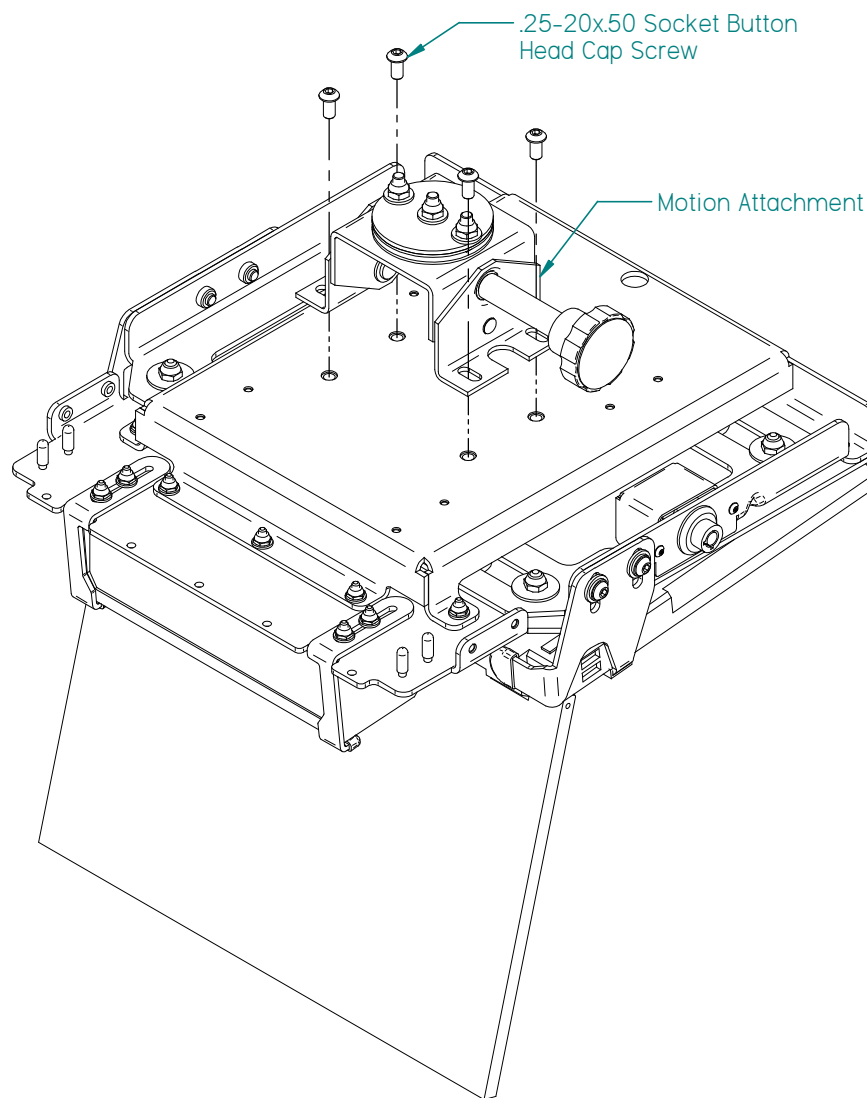

Figure 3

Product Mounting Disclaimer

Gamber-Johnson is not liable under any theory of contract or tort law for any loss, damage, personal injury, special, incidental or consequential damages for personal injury or other damage of any nature arising directly or indirectly as a result of the improper installation or use of its products in vehicle or any other application. In order to safely install and use Gamber-Johnson products full consideration of vehicle occupants, vehicle systems (i.e., the location of fuel lines, brakes lines, electrical, drive train or other systems), air-bags and other safety equipment is required. Gamber-Johnson specifically disclaims any responsibility for the improper use or installation of its products not consistent with the original vehicle manufactures specifications and recommendations, Gamber-Johnson product instruction sheets, or workmanship standards as endorsed through the Gamber-Johnson Certified Installer Program. The OEM port replicators used in docking cradles are not warranted by Gamber-Johnson.

If you need assistance or have questions, call Gamber-Johnson at 1-800-456-6868



Very Well Connected™

INSTALLATION INSTRUCTIONS

<u>Product</u>	<u>Revision</u>	<u>Form</u>
7160-0201 CRADLE, DELL E-6400, E-6400 ATG	Rev. A	INST-438

Accessories

Tools Needed

9/64 hex-key wrench
11/32 box wrench
#2 Philips screw driver

Screen Support

1. Secure the screen support to the left side of the cradle using (2) #8-32 x .50 socket head cap screws and (2) #8 flat washers with the 9/64 hex-key wrench.
2. Loosen (2) #8-32 x .50 socket head cap screws and #8 lock nuts then adjust the screen support width. Secure the fasteners after the adjustment.

Light

- Secure the light to the right side of the cradle using (2) #8-32 x .50 socket head cap screws and (2) #8 flat washers with the 9/64 hex-key wrench.

Isolator Plate

1. Secure four dampers using (8) #6-32 x .25 pan head screws.
2. Secure the isolator plate using (4) #8-32 x .38 pan head screws.

Product Mounting Disclaimer

Gamber-Johnson is not liable under any theory of contract or tort law for any loss, damage, personal injury, special, incidental or consequential damages for personal injury or other damage of any nature arising directly or indirectly as a result of the improper installation or use of its products in vehicle or any other application. In order to safely install and use Gamber-Johnson products full consideration of vehicle occupants, vehicle systems (i.e., the location of fuel lines, brakes lines, electrical, drive train or other systems), air-bags and other safety equipment is required. Gamber-Johnson specifically disclaims any responsibility for the improper use or installation of its products not consistent with the original vehicle manufactures specifications and recommendations, Gamber-Johnson product instruction sheets, or workmanship standards as endorsed through the Gamber-Johnson Certified Installer Program. The OEM port replicators used in docking cradles are not warranted by Gamber-Johnson.

If you need assistance or have questions, call Gamber-Johnson at 1-800-456-6868

INSTALLATION INSTRUCTIONS

Product

7160-0201
CRADLE, DELL E-6400, E-6400 ATG

Revision

Rev. A

Form

INST-438

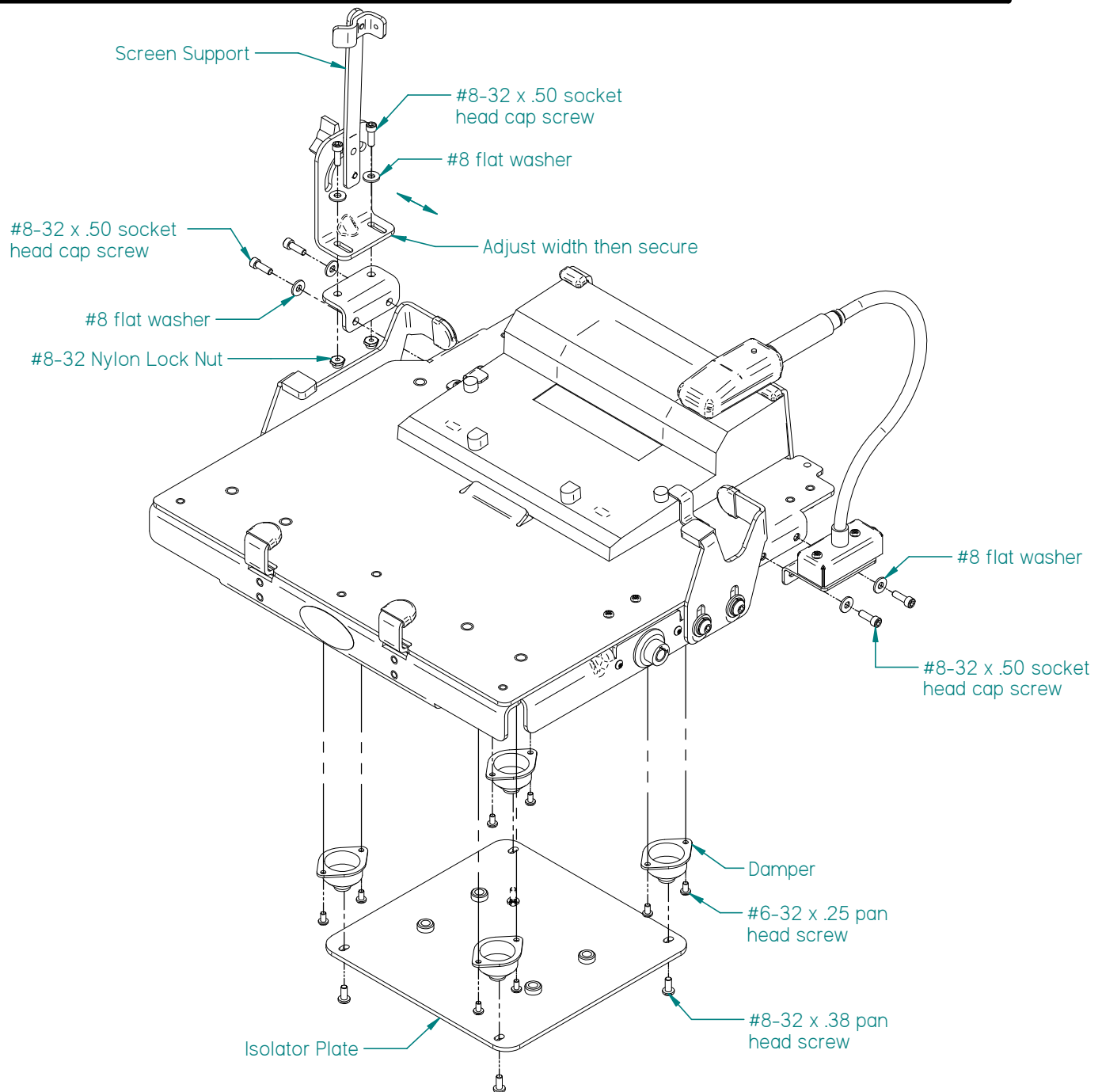

Figure 4

Product Mounting Disclaimer

Gamber-Johnson is not liable under any theory of contract or tort law for any loss, damage, personal injury, special, incidental or consequential damages for personal injury or other damage of any nature arising directly or indirectly as a result of the improper installation or use of its products in vehicle or any other application. In order to safely install and use Gamber-Johnson products full consideration of vehicle occupants, vehicle systems (i.e., the location of fuel lines, brakes lines, electrical, drive train or other systems), air-bags and other safety equipment is required. Gamber-Johnson specifically disclaims any responsibility for the improper use or installation of its products not consistent with the original vehicle manufactures specifications and recommendations, Gamber-Johnson product instruction sheets, or workmanship standards as endorsed through the Gamber-Johnson Certified Installer Program. The OEM port replicators used in docking cradles are not warranted by Gamber-Johnson.

If you need assistance or have questions, call Gamber-Johnson at 1-800-456-6868