

RUGGED.

DOCKING STATIONS AND VEHICLE MOUNTS

NEW

Ford Transit Connect (2010)

Placement	Seat Configurations	Drilling Required	Recommended Pole Solution	Weight	Height	Width	Depth
Passenger side on the floor - under seat	Bucket	No - attaches to seat studs: <i>Ford Transit Connect (2010)</i>	Lower Pole: DS-LOWER-9 Upper Pole: QADJ-UPPER-M Support Brace: 7160-0230 Motion Attachment: DS-CLEVIS Poles and Motion Attachments ordered separately	3.0 lbs	3.99"	5.25"	7.77"

Features

- Heavy gauge steel construction for long-term durability
- Black powdercoat finish for maximum corrosion resistance
- Will not interfere with levers or factory installed console
- A *Support Brace* (Item No. 7160-0230) is highly recommended

Item No. 7160-0245

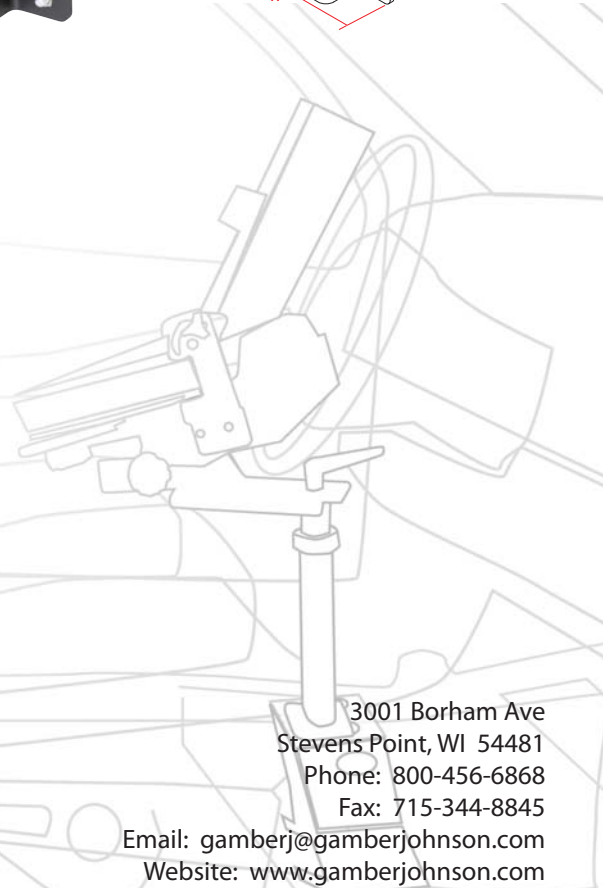
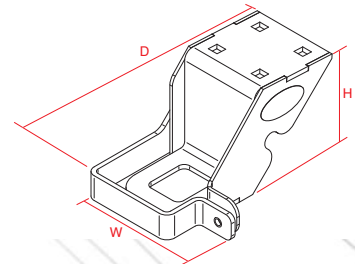

**GAMBER
JOHNSON®**

Very Well Connected™

3001 Borham Ave
Stevens Point, WI 54481
Phone: 800-456-6868
Fax: 715-344-8845

Email: gamberj@gamberjohnson.com
Website: www.gamberjohnson.com