

DEFINING RUGGED

EXCEPTIONAL ENGINEERING | ROCK SOLID | EXTENSIVE TESTING



FORKLIFT MOUNT: 0-90 CLEVIS

| Placement | Tilt | Swivel | Weight | Height | Width | Depth |
|--|-------------------------------------|---|-----------|--------|-------|-------|
| Attaches to any <i>Clam Shell</i> (Item No. 7160-0357, 7160-0370, 7160-0371) | Yes - up to 90° fore/30° aft | Motion Attachment - 360° Entire arm - 360° | 3.28 lbs. | 3.5" | 8.06" | 6.63" |

Features:

- Heavy gauge steel construction for long-term durability in a rugged environment
- Black powdercoat finish for maximum corrosion resistance
- The entire arm can rotate around 360° and the Motion Attachment can also rotate 360°
- Arm extends 3" bringing equipment closer to the user
- Arm can be tighten down to be locked into a permanent position
- Tilt capabilities:
 - 90° forward allows for tablets to be easily mounted
 - 30° aft movement with a positive stop at 30°
 - Riveted design allows for smoother tilt movement
- Easier installation:
 - Open throat design for ease of mounting to docking stations and cradles
- Can be mounted directly to any *Clam Shell* (Item No. 7160-0357, 7160-0370, 7160-0371)

Item No. 7160-0356

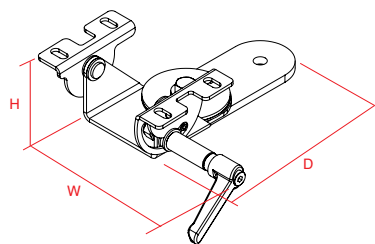

Very Well Connected™

3001 Borham Ave. | Stevens Point, WI 54481, USA
 Phone: 715.344.3482 | Toll-free: 800.487.9220 | Fax: 715.344.5209
 Email: gamberj@gamberjohnson.com | Website: www.gamberjohnson.com

Follow us on:



This document, including images, may not be reproduced partly or fully without the expressed written consent of Gamber-Johnson's Marketing Department.
 © Copyright 2014 Gamber-Johnson LLC