

DEFINING RUGGED

EXCEPTIONAL ENGINEERING | ROCK SOLID | EXTENSIVE TESTING

NEW

6" LOCKING SLIDE ARM

Placement	Tilt	Rotates	Slide	Weight	Height	Width	Depth
Any <i>Upper Pole, Complete Pole, Low Profile Brackets, Center Pole</i> or directly to any flat surface	Yes - up to 90° fore/ 30° aft	Motion Attachment - 360° Entire arm - 360° can lock at every 15°	Yes - up to 5.5" fore/aft	4.6 lbs	3.61"	5.0"	9.56"

Features:

- The entire arm can rotate around 360° with locking points at every 15°
- To rotate the arm simply pull the front lever out, rotate to desired position and then release the lever
- Locking slide arm can slide up to 5.5" from the center of the pole
- Motion Attachment:
 - Tilt capabilities:
 - 90° forward allows for tablets to be easily mounted
 - 30° aft movement with a positive stop at 30°
 - Riveted design allows for smoother tilt movement
 - Rotation capabilities:
 - Motion Attachment can rotate 360° allowing for maximum flexibility in computer placement
 - Easier installation:
 - Open throat design for ease of mounting to docking stations and cradles
- Can be mounted directly to a flat surface or on any *Upper Pole, Complete Pole, Center Pole, Low Profile Bracket* or *Smiley Face Pattern*
- Heavy gauge steel construction for long-term durability
- Black powdercoat finish for maximum corrosion resistance

Item No. **7160-0500**

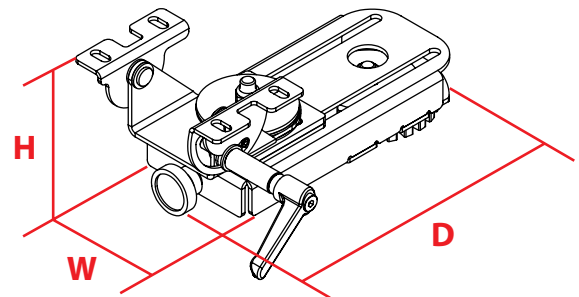

Very Well Connected™

3001 Borham Ave. | Stevens Point, WI 54481, USA
 Phone: 715.344-3482 | Toll-free: 800.487-9220 | Fax: 715.344-5209
 Email: gamberj@gamberjohnson.com | Website: www.gamberjohnson.com

Follow us on:

This document, including images, may not be reproduced partly or fully without the expressed written consent of Gamber-Johnson's Marketing Department.
 © Copyright 2013 Gamber-Johnson LLC